

# 鹤山市2023年度第五十九批次城镇建设用征收土地红线图

单位: m.m<sup>2</sup>

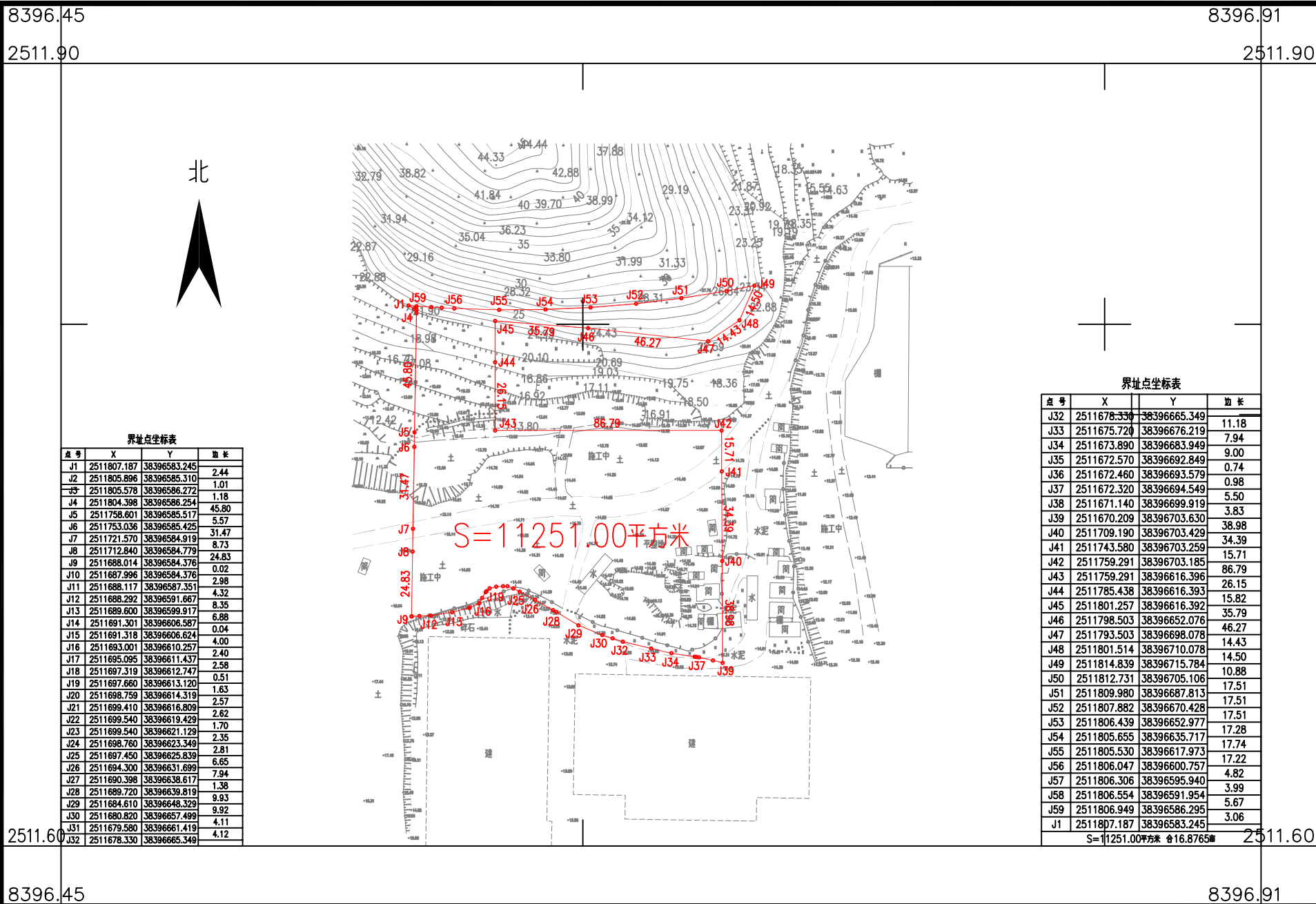

界址点坐标表

点号	X	Y	边长
J1	2511807.187	38396583.245	2.44
J2	2511805.896	38396585.310	1.01
J3	2511805.578	38396586.272	1.18
J4	2511804.398	38396586.254	45.80
J5	2511758.601	38396585.517	5.57
J6	2511753.036	38396585.425	31.47
J7	2511721.570	38396584.919	8.73
J8	2511712.840	38396584.779	24.83
J9	2511688.014	38396584.376	0.02
J10	2511687.996	38396584.376	2.98
J11	2511688.117	38396587.351	4.32
J12	2511688.292	38396591.667	8.35
J13	2511689.600	38396599.917	6.88
J14	2511691.301	38396606.587	0.04
J15	2511691.318	38396606.624	4.00
J16	2511693.001	38396610.257	2.40
J17	2511695.095	38396611.437	2.58
J18	2511697.319	38396612.747	0.51
J19	2511697.660	38396613.120	1.63
J20	2511698.759	38396614.319	2.57
J21	2511699.410	38396616.809	2.62
J22	2511699.540	38396619.429	1.70
J23	2511699.540	38396621.129	2.35
J24	2511698.760	38396623.349	2.81
J25	2511697.450	38396625.839	6.65
J26	2511694.300	38396631.699	7.94
J27	2511690.398	38396638.617	1.38
J28	2511689.720	38396639.819	9.83
J29	2511694.610	38396648.329	9.92
J30	2511680.820	38396657.499	4.11
J31	2511679.580	38396661.419	4.12
J32	2511678.330	38396665.349	

界址点坐标表

点号	X	Y	边长
J32	2511678.330	38396665.349	11.18
J33	2511675.720	38396676.219	7.94
J34	2511673.890	38396683.949	9.00
J35	2511672.570	38396692.849	0.74
J36	2511672.460	38396693.579	0.98
J37	2511672.320	38396694.549	5.50
J38	2511671.140	38396699.919	3.83
J39	2511670.209	38396703.630	38.98
J40	2511709.190	38396703.429	34.39
J41	2511743.580	38396703.259	15.71
J42	2511759.291	38396703.185	86.79
J43	2511759.291	38396616.396	26.15
J44	2511785.438	38396616.393	15.82
J45	2511801.257	38396616.392	35.79
J46	2511798.503	38396652.076	46.27
J47	2511793.503	38396698.078	14.43
J48	2511801.514	38396710.078	14.50
J49	2511814.839	38396715.784	10.88
J50	2511812.731	38396705.106	17.51
J51	2511809.980	38396687.813	17.51
J52	2511807.882	38396670.428	17.51
J53	2511806.439	38396652.977	17.28
J54	2511805.655	38396635.717	17.74
J55	2511805.530	38396617.973	17.22
J56	2511806.047	38396600.757	4.82
J57	2511806.306	38396595.940	3.99
J58	2511806.554	38396591.954	5.67
J59	2511806.949	38396586.295	3.06
J1	2511807.187	38396583.245	

S=11251.00平方米 合16.8765亩

鹤山市城乡规划建设院有限公司

2025年04月数字化制图。  
2000国家大地坐标系: 中央子午线114度。  
1985国家高程基准, 等高距为1米。  
2007年版式。

1:2000

绘图员: 廖正君  
检查员: 张纯雯  
审核员: 谭锦峰